



12 Cade Court Jindera NSW

4  2  2 

Welcome home to a young quality-built residence where luxury meets tranquillity in this spacious and well-appointed family home. This classy 4-bedroom home effortlessly combines style, warmth, and functionality.

Set in the thriving country township of Jindera, within a quiet court location, you can experience the best of both worlds with a peaceful environment and easy access to the town's amenities.

The exquisite property is located close to the IGA, local cafes, pub, Hume Bank, pharmacy, vet, sporting facilities, swimming pool, and local schools as well as only being 15 minutes to Lavington shopping precinct and 20 minutes to Albury's CBD.

This remarkable home will captivate all smart buyers,

Price : \$719,000
Building Size : 216 sqm
Land Size : 793 sqm
View : <https://www.gyre.com.au/sale/nsw/murray-region/jindera/residential/house/7936981>



Clinton Gilson
02 6040 6818

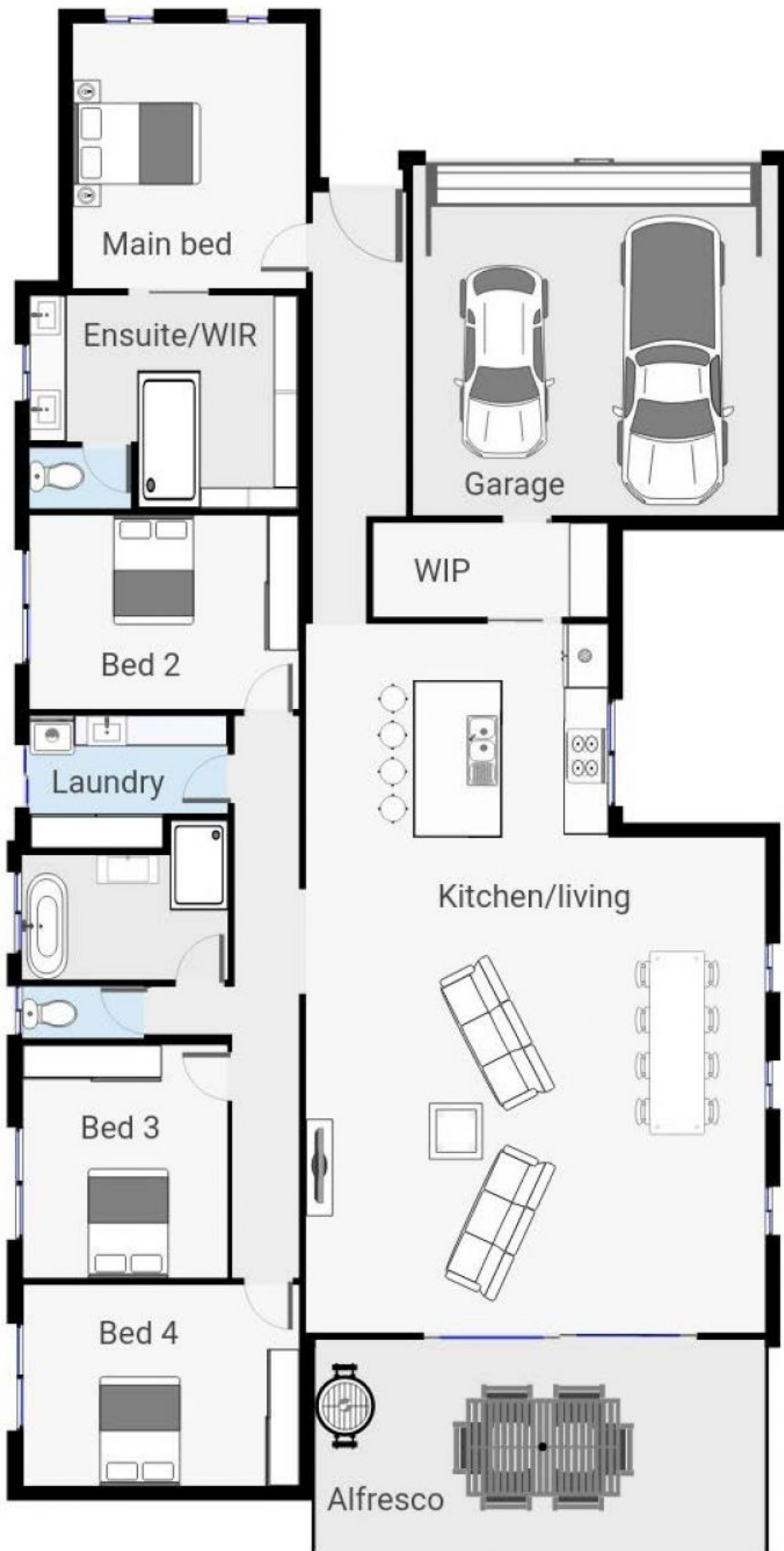

Please note: This plan has been generated for advertising only and may not be exact. Interested parties are to do their due diligence to verify any information provided in this plan.